

# M60/M62/M66 Simister Island Interchange

TR010064

## ENVIRONMENTAL STATEMENT FIGURES CHAPTER 7 LANDSCAPE AND VISUAL (FIGURE 7.7)

APFP 5(2)(a)

Planning Act 2008

Infrastructure Planning (Applications: Prescribed  
Forms and Procedure) Regulations 2009

Infrastructure Planning

Planning Act 2008

**The Infrastructure Planning  
(Applications: Prescribed Forms and  
Procedure) Regulations 2009**

**M60/M62/M66 Simister Island Interchange**  
Development Consent Order 202[ ]

---

**ENVIRONMENTAL STATEMENT FIGURES**  
**CHAPTER 7 LANDSCAPE AND VISUAL (FIGURE 7.7)**

---

<b>Regulation Reference</b>	5(2)(a)
<b>Planning Inspectorate Scheme Reference</b>	TR010064
<b>Application Document Reference</b>	TR010064/APP/6.2
<b>Author</b>	M60/M62/M66 Simister Island Interchange Costain Jacobs Partnership Project Team & National Highways

<b>Version</b>	<b>Date</b>	<b>Status of Version</b>
P02	November 2024	DEADLINE 3 UPDATE

## **CONTENTS**

**Environmental Statement Figures Chapter 7 Landscape and Visual (Figure 7.7) .....1**

## **Environmental Statement Figures Chapter 7 Landscape and Visual (Figure 7.7)**

- 1.1.1 This document contains the following figure:
- Figure 7.7 Photomontages

**EXISTING - WINTER BASELINE**



**PHOTOMONTAGE - WINTER YEAR 1 OF OPERATION**



**VIEWPOINT PM01:** View looking south west from Egypt Lane, footpath 9WHI and 46WHI, Simister to the Northern Loop, Pike Fold Viaduct and Bridge.

Visualisation type: Type 3 (in accordance with Landscape Institute Visual Representation of Development Proposals Technical Guidance Note 06/19)  
 Date and time of photograph: 07/02/22 at 10.55  
 Lighting conditions: Overcast  
 OS grid reference: 383159 , 406636  
 Viewpoint ground elevation: 91 m  
 Projection: Cylindrical  
 Sheet size: A1

Enlargement factor: 96% @ A1  
 Camera type: Canon EOS 5D MARK III  
 Camera lens size: 50 mm  
 Camera height above ground level: 1.6 m  
 Aperture: F/9  
 Shutter speed: 1/320  
 ISO: 400  
 Horizontal field of view: 90°  
 Vertical field of view: 27°  
 Bearing to centre of panoramic: 223°

Rev	Rev. Date	Purpose of revision	Drawn	Checked	Rev'd	Approved
P01	22/12/23	FOR DCO APPLICATION	RL	JP	JP	BB

**NOTES:**  
 1. This photomontage is for illustrative purposes only and has been prepared in accordance with the methodology set out in Appendix 7.1 of the Environmental Statement Appendices [TR010064/APP/6.3].  
 2. For larger plans showing all viewpoint locations, refer to Figure 7.5 of the Environmental Statement Figures [TR010064/APP/6.2].  
 3. If using this photomontage to judge scale, view at A1 sheet size. The A1 sheet should be viewed centrally at a comfortable arm's length. If using this photomontage for landscape context, the figure may be viewed at A3 sheet size or viewed online.  
 4. If viewing these figures online, images will be low-resolution and therefore should only be used for information purposes. High resolution versions of the figures can be obtained from National Highways on request if required.

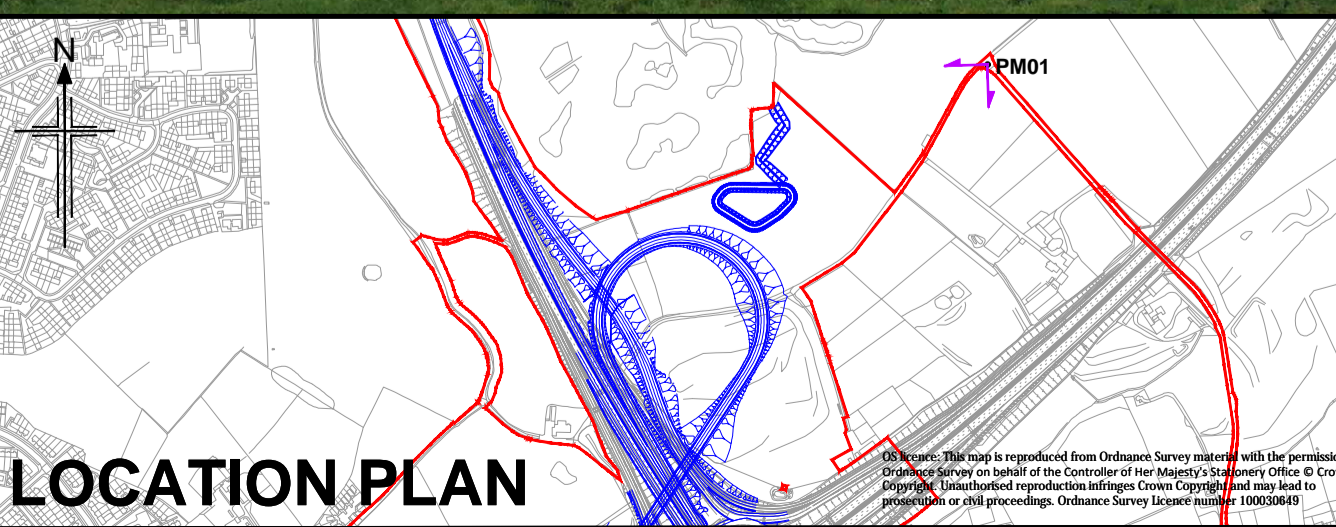

Development Consent Order Number TR010064	Development Consent Order Drawing Number TR010064/APP/6.2	Project M60/M62/M66 SIMISTER ISLAND INTERCHANGE
Regulation Regulation 5(2)(a)		Drawing Title FIGURE 7.7 PHOTOMONTAGES VIEWPOINT PM01 WINTER YEAR 1 (SHEET 1 OF 2)
Purpose of issue DCO APPLICATION	Drawing Status S4	
Scale at A1 (841x594mm) N/A@A1	Jacobus No B36601F0	Client No HE548642
Client 	Drawing Number HE548642 - SII_MLT	Originator JAC
	Volume - ELS -	Role -VS- L -0201

Rev P01
------------

**EXISTING - SUMMER BASELINE**



**PHOTOMONTAGE - SUMMER YEAR 15 OF OPERATION**



**VIEWPOINT PM01:** View looking south west from Egypt Lane, footpath 9WHI and 46WHI, Simister to the Northern Loop, Pike Fold Viaduct and Bridge.

Visualisation type: Type 3 (in accordance with Landscape Institute Visual Representation of Development Proposals Technical Guidance Note 06/19)  
 Date and time of photograph: 08/09/21 at 11.15  
 Lighting conditions: Sunny  
 OS grid reference: 383163 , 406638  
 Viewpoint ground elevation: 91 m  
 Projection: Cylindrical  
 Sheet size: A1

Enlargement factor: 96% @ A1  
 Camera type: Canon EOS 5D MARK III  
 Camera lens size: 50 mm  
 Camera height above ground level: 1.6 m  
 Aperture: F/9  
 ISO: 200  
 Shutter speed: 1/800  
 Horizontal field of view: 90°  
 Vertical field of view: 27°  
 Bearing to centre of panoramic: 223°

Rev	Rev. Date	Purpose of revision	Drawn	Checked	Rev'd	Apprv'd
P02	04/11/24	UPDATED FOR DEADLINE 3	RL	JP	JP	AP
P01	22/12/23	FOR DCO APPLICATION	RL	JP	JP	BB

**NOTES:**

- This photomontage is for illustrative purposes only and has been prepared in accordance with the methodology set out in Appendix 7.1 of the Environmental Statement Appendices [TR010064/APP/6.3]
- For larger plans showing all viewpoint locations, refer to Figure 7.5 of the Environmental Statement Figures [TR010064/APP/6.2]
- If using this photomontage to judge scale, view at A1 sheet size. The A1 sheet should be viewed centrally at a comfortable arm's length. If using this photomontage for landscape content, the figure may be viewed at A3 sheet size or viewed online.
- If viewing these figures online, images will be low-resolution and therefore should only be used for information purposes. High resolution versions of the figures can be obtained from National Highways on request if required.

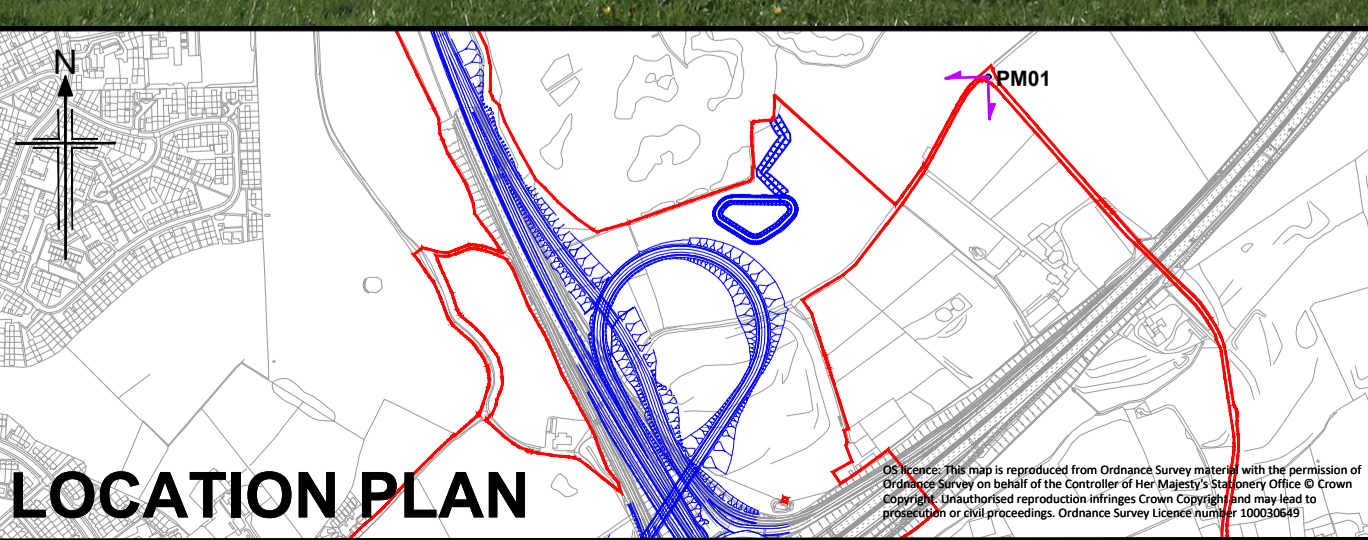

Development Consent Order Number <b>TR010064</b>	Development Consent Order Drawing Number <b>TR010064/APP/6.2</b>	Project <b>M60/M62/M66 SIMISTER ISLAND INTERCHANGE</b>
Regulation <b>Regulation 5(2)(a)</b>	Purpose of Issue <b>DEADLINE 3 UPDATE</b>	Drawing Title <b>FIGURE 7.7 PHOTOMONTAGES VIEWPOINT PM01 SUMMER YEAR 15 (SHEET 2 OF 2)</b>
Scale at A1 (841x594mm) <b>N/A@A1</b>	Client <b>national highways</b>	Jacobs No <b>B36601F0</b>
		Client No <b>HE548642</b>
		Rev <b>P02</b>
		Drawing Number <b>HE548642 - SII MLT</b>
		Originator <b>JAC</b>
		Volume <b>- ELS -</b>
		Type <b>-VS-</b>
		Role <b>L</b>
		Number <b>-0202</b>

**EXISTING - WINTER BASELINE**



**PHOTOMONTAGE - WINTER YEAR 1 OF OPERATION**



**VIEWPOINT PM02: View looking east from Marston Close in Whitefield to the Simister Pike Fold Viaduct and new embankment.**

Visualisation type: Type 3 (in accordance with Landscape Institute Visual Representation of Development Proposals Technical Guidance Note 06/19)  
 Date and time of photograph: 07/02/22 at 11:40  
 Lighting conditions: Overcast  
 OS grid reference: 382326, 405949  
 Viewpoint ground elevation: 97 m  
 Projection: Cylindrical  
 Sheet size: A1

Enlargement factor: 96% @ A1  
 Camera type: Canon EOS 5D MARK III  
 Camera lens size: 50 mm  
 Camera height above ground level: 1.6 m  
 Aperture: F/8  
 ISO: 200  
 Shutter speed: 1/250  
 Horizontal field of view: 90°  
 Vertical field of view: 27°  
 Bearing to centre of panoramic: 100°

Rev	Rev. Date	Purpose of revision	Drawn	Checkd	Rev'd	Apprv'd
P01	22/12/23	FOR DCO APPLICATION	RL	JP	JP	BB

**NOTES:**  
 1. This photomontage is for illustrative purposes only and has been prepared in accordance with the methodology set out in Appendix 7.1 of the Environmental Statement Appendices [TR010064/APP/6.3].  
 2. For larger plans showing all viewpoint locations, refer to Figure 7.5 of the Environmental Statement Figures [TR010064/APP/6.2].  
 3. If using this photomontage to judge scale, view at A1 sheet size. The A1 sheet should be viewed centrally at a comfortable arm's length. If using this photomontage for landscape context, the figure may be viewed at A3 sheet size or viewed online.  
 4. If viewing these figures online, images will be low-resolution and therefore should only be used for information purposes. High resolution versions of the figures can be obtained from National Highways on request if required.

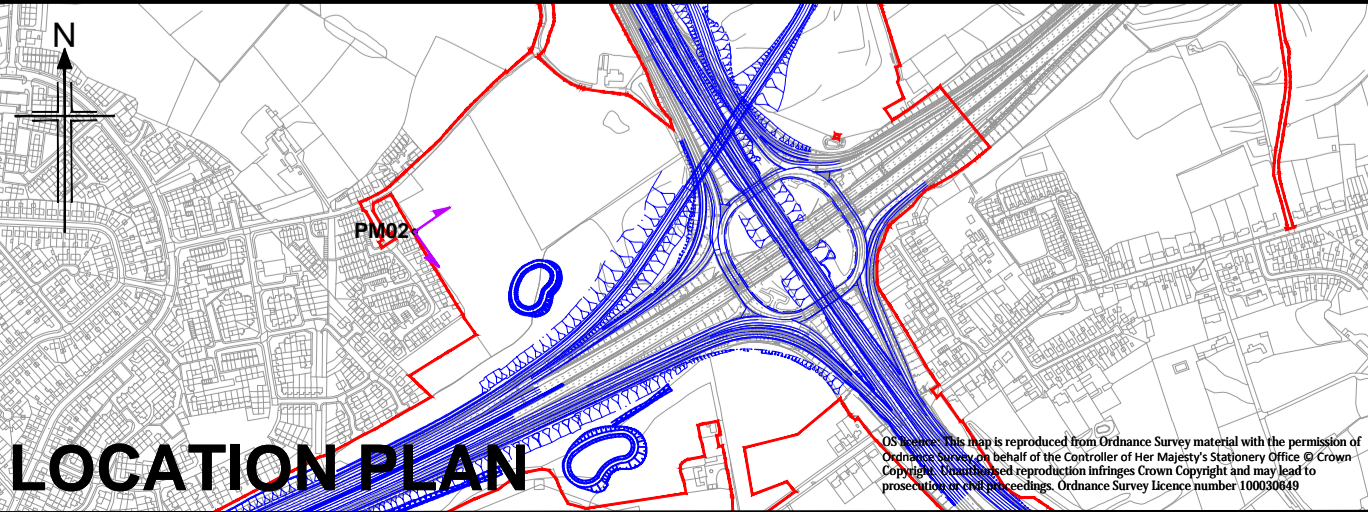

Development Consent Order Number TR010064	Development Consent Order Drawing Number TR010064/APP/6.2	Project M60/M62/M66 SIMISTER ISLAND INTERCHANGE
Regulation Regulation 5(2)(a)	Purpose of issue DCO APPLICATION	Drawing Title FIGURE 7.7 PHOTOMONTAGES VIEWPOINT PM02 WINTER YEAR 1 (SHEET 1 OF 2)
Scale at A1 (841x594mm) N/A@A1	Client national highways	Jacobs No B36601F0
Client national highways	Originator JAC	Client No HE548642
Client national highways	Volume ELS	Rev P01
Client national highways	Location SII_MLT	Role -VS- L -0203

**EXISTING - SUMMER BASELINE**



**PHOTOMONTAGE - SUMMER YEAR 15 OF OPERATION**



**VIEWPOINT PM02: View looking east from Marston Close in Whitefield to the Simister Pike Fold Viaduct and new embankment.**

Visualisation type: Type 3 (in accordance with Landscape Institute Visual Representation of Development Proposals Technical Guidance Note 06/19)  
 Date and time of photograph: 08/09/21 at 16.32  
 Lighting conditions: Sunny/Clear  
 OS grid reference: 382336, 405953  
 Viewpoint ground elevation: 97 m  
 Projection: Cylindrical  
 Sheet size: A1

Enlargement factor: 96% @ A1  
 Camera type: Canon EOS 5D MARK III  
 Camera lens size: 50 mm  
 Camera height above ground level: 1.6 m  
 Aperture: F/9  
 ISO: 200  
 Shutter speed: 1/320  
 Horizontal field of view: 90°  
 Vertical field of view: 27°  
 Bearing to centre of panoramic: 100°

Rev	Rev. Date	Purpose of revision	Drawn	Checked	Rev'd	Apprv'd
P02	04/11/24	UPDATED FOR DEADLINE 3	RL	JP	JP	AP
P01	22/12/23	FOR DCO APPLICATION	RL	JP	JP	BB

**NOTES:**

- This photomontage is for illustrative purposes only and has been prepared in accordance with the methodology set out in Appendix 7.1 of the Environmental Statement Appendices [TR010064/APP/6.3]
- For larger plans showing all viewpoint locations, refer to Figure 7.5 of the Environmental Statement Figures [TR010064/APP/6.2]
- If using this photomontage to judge scale, view at A1 sheet size. The A1 sheet should be viewed centrally at a comfortable arm's length. If using this photomontage for landscape context, the figure may be viewed at A3 sheet size or viewed online.
- If viewing these figures online, images will be low-resolution and therefore should only be used for information purposes. High resolution versions of the figures can be obtained from National Highways on request if required.

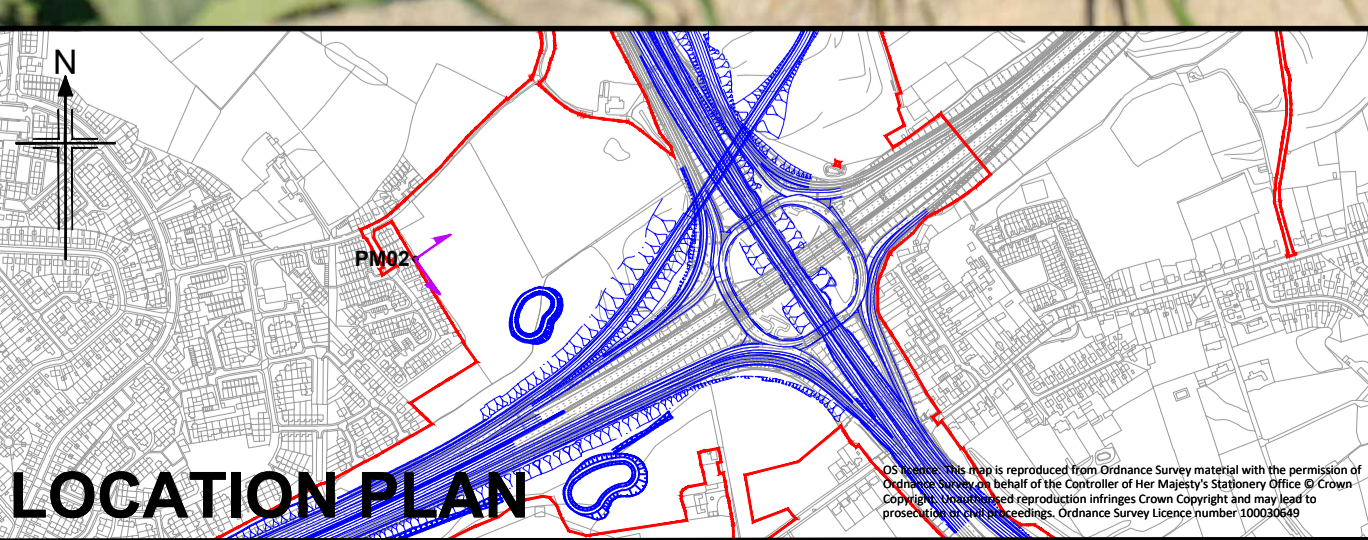

Development Consent Order Number <b>TR010064</b>	Development Consent Order Drawing Number <b>TR010064/APP/6.2</b>	Project <b>M60/M62/M66 SIMISTER ISLAND INTERCHANGE</b>
Regulation <b>Regulation 5(2)(a)</b>		Drawing Title <b>FIGURE 7.7 PHOTOMONTAGES VIEWPOINT PM02 SUMMER YEAR 15 (SHEET 2 OF 2)</b>
Purpose of Issue <b>DEADLINE 3 UPDATE</b>	Drawing Status <b>S4</b>	Jacobs No <b>B36601F0</b>
Scale at A1 (841x594mm) <b>N/A@A1</b>	Client No <b>HE548642</b>	Rev <b>P02</b>
Client <b>national highways</b>	Drawing Number <b>HE548642 - SII MLT</b>	Originator <b>JAC</b>
	Volume <b>- ELS -</b>	Role <b>-VS- L -0204</b>



**EXISTING - WINTER BASELINE**



**PHOTOMONTAGE - WINTER YEAR 1 OF OPERATION**



**VIEWPOINT PM03: View looking south from Derwent Avenue towards the M60 on the existing embankment.**

Visualisation type: Type 3 (in accordance with Landscape Institute Visual Representation of Development Proposals Technical Guidance Note 06/19)  
 Date and time of photograph: 01/12/22 at 11:40  
 Lighting conditions: Cloudy  
 OS grid reference: 382105, 405664  
 Viewpoint ground elevation: 98 m  
 Projection: Cylindrical  
 Sheet size: A1

Enlargement factor: 96% @ A1  
 Camera type: Canon EOS 6D MARK II  
 Camera lens size: 50 mm  
 Camera height above ground level: 1.6 m  
 Aperture: F/7.1  
 ISO: 200  
 Shutter speed: 1/40  
 Horizontal field of view: 90°  
 Vertical field of view: 27°  
 Bearing to centre of panoramic: 180°

Rev	Rev. Date	Purpose of revision	Drawn	Checked	Rev'd	Apprv'd
P01	22/12/23	FOR DCO APPLICATION	RL	JP	JP	BB

**NOTES:**

- This photomontage is for illustrative purposes only and has been prepared in accordance with the methodology set out in Appendix 7.1 of the Environmental Statement Appendices [TR010064/APP.3].
- For larger plans showing all viewpoint locations, refer to Figure 7.5 of the Environmental Statement Figures [TR010064/APP.6.2].
- If using this photomontage to judge scale, view at A1 sheet size. The A1 sheet should be viewed centrally at a comfortable arm's length. If using this photomontage for landscape context, the figure may be viewed at A3 sheet size or viewed online.
- If viewing these figures online, images will be low-resolution and therefore should only be used for information purposes. High resolution versions of the figures can be obtained from National Highways on request if required.

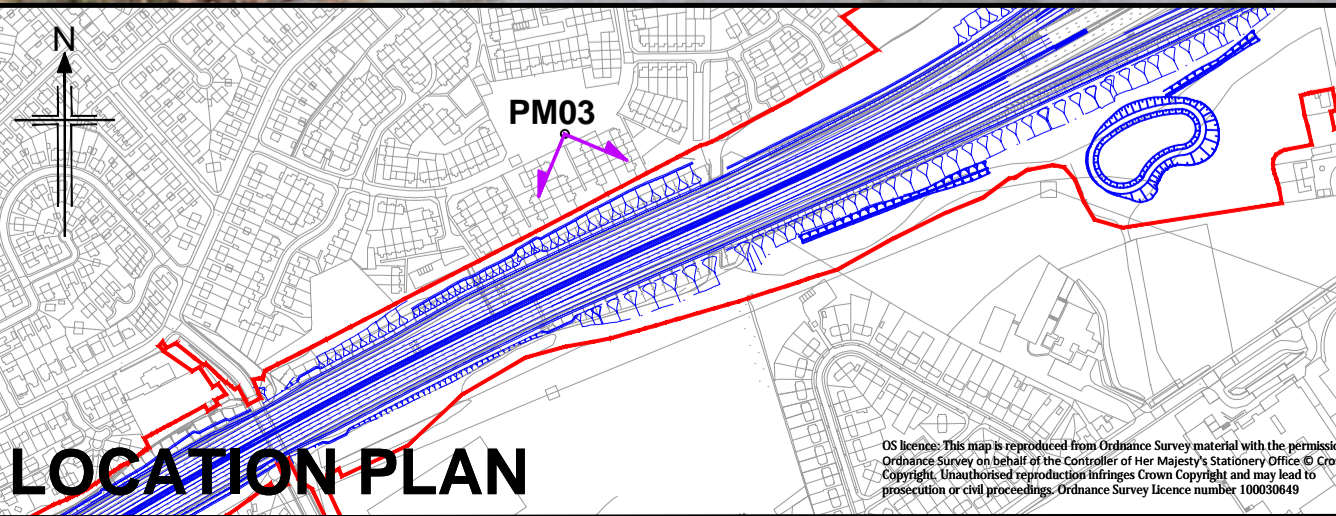

Development Consent Order Number TR010064	Development Consent Order Drawing Number TR010064/APP/6.2	Project M60/M62/M66 SIMISTER ISLAND INTERCHANGE
Regulation Regulation 5(2)(a)	Purpose of issue DCO APPLICATION	Drawing Status S4
Scale at A1 (841x594mm) N/A@A1	Jacobs No B36601F0	Client No HE548642
Client 	Drawing Number HE548642 - SII_MLT	Originator JAC
		Volume - ELS -
		Role -VS- L -0205
		Rev P01

EXISTING - SUMMER BASELINE



PHOTOMONTAGE - SUMMER YEAR 15 OF OPERATION



VIEWPOINT PM03: View looking south from Derwent Avenue towards the M60 on the existing embankment.

Visualisation type: Type 3 (in accordance with Landscape Institute Visual Representation of Development Proposals Technical Guidance Note 06/19)  
 Date and time of photograph: 05/10/22 at 14:33  
 Lighting conditions: Sunny  
 OS grid reference: 382099, 405655  
 Viewpoint ground elevation: 98 m  
 Projection: Cylindrical  
 Sheet size: A1

Enlargement factor: 96% @ A1  
 Camera type: Canon EOS 6D MARK II  
 Camera lens size: 50 mm  
 Camera height above ground level: 1.6 m  
 Aperture: F/7.1  
 ISO: 200  
 Shutter speed: 1/125  
 Horizontal field of view: 90°  
 Vertical field of view: 27°  
 Bearing to centre of panoramic: 180°

Rev	Rev. Date	Purpose of revision	Drawn	Checked	Rev'd	Approved
P01	22/12/23	FOR DCO APPLICATION	RL	JP	JP	BB

NOTES:  
 1. This photomontage is for illustrative purposes only and has been prepared in accordance with the methodology set out in Appendix 7.1 of the Environmental Statement Appendices [TR010064/APP/6.3].  
 2. For larger plans showing all viewpoint locations, refer to Figure 7.5 of the Environmental Statement Figures [TR010064/APP/6.2].  
 3. If using this photomontage to judge scale, view at A1 sheet size. The A1 sheet should be viewed centrally at a comfortable arm's length. If using this photomontage for landscape context, the figure may be viewed at A3 sheet size or viewed online.  
 4. If viewing these figures online, images will be low-resolution and therefore should only be used for information purposes. High resolution versions of the figures can be obtained from National Highways on request if required.

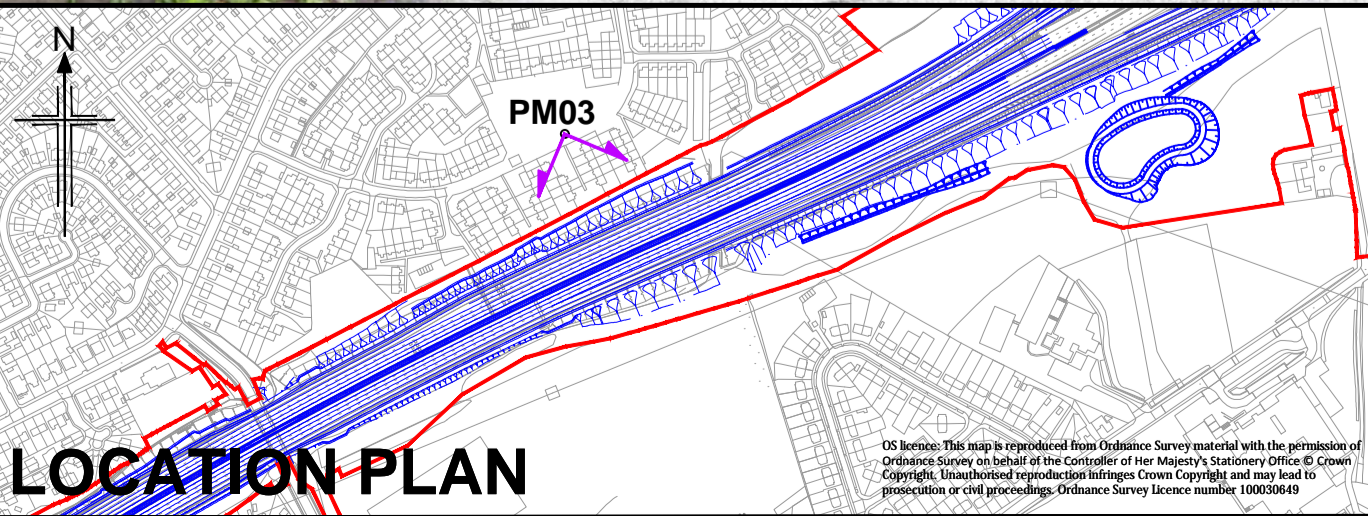

Development Consent Order Number TR010064	Development Consent Order Drawing Number TR010064/APP/6.2	Project M60/M62/M66 SIMISTER ISLAND INTERCHANGE
Regulation Regulation 5(2)(a)	Purpose of issue DCO APPLICATION	Drawing Title FIGURE 7.7 PHOTOMONTAGES VIEWPOINT PM03 SUMMER YEAR 15 (SHEET 2 OF 2)
Scale at A1 (841x594mm) N/A@A1	Client national highways	Jacobus No B36601F0
		Client No HE548642
		Rev P01
		Drawing Number HE548642 - SII_MLT
		Originator JAC
		Volume - ELS -
		Type   Role   Number -VS- L -0206

**EXISTING - WINTER BASELINE**



**PHOTOMONTAGE - WINTER YEAR 1 OF OPERATION**



**VIEWPOINT PM04:** View looking north-east from Heywood Road near Parrenthorn High School to the new M60 west bound on-slip.

Visualisation type: Type 3 (in accordance with Landscape Institute Visual Representation of Development Proposals Technical Guidance Note 06/19)  
 Date and time of photograph: 25/03/21 at 14.00  
 Lighting conditions: Partially cloudy  
 OS grid reference: 382611, 405459  
 Viewpoint ground elevation: 103 m  
 Projection: Cylindrical  
 Sheet size: A1

Enlargement factor: 96% @ A1  
 Camera type: Canon EOS 5D MARK III  
 Camera lens size: 50 mm  
 Camera height above ground level: 1.6 m  
 Aperture: F/7.1  
 ISO: 400  
 Shutter speed: 1/2500  
 Horizontal field of view: 90°  
 Vertical field of view: 27°  
 Bearing to centre of panoramic: 40°

Rev	Rev. Date	Purpose of revision	Drawn	Checked	Rev'd	Approved
P01	22/12/23	FOR DCO APPLICATION	RL	JP	JP	BB

**NOTES:**  
 1. This photomontage is for illustrative purposes only and has been prepared in accordance with the methodology set out in Appendix 7.1 of the Environmental Statement Appendices [TR010064/APP/6.3].  
 2. For larger plans showing all viewpoint locations, refer to Figure 7.5 of the Environmental Statement Figures [TR010064/APP/6.2].  
 3. If using this photomontage to judge scale, view at A1 sheet size. The A1 sheet should be viewed centrally at a comfortable arm's length. If using this photomontage for landscape context, the figure may be viewed at A3 sheet size or viewed online.  
 4. If viewing these figures online, images will be low-resolution and therefore should only be used for information purposes. High resolution versions of the figures can be obtained from National Highways on request if required.

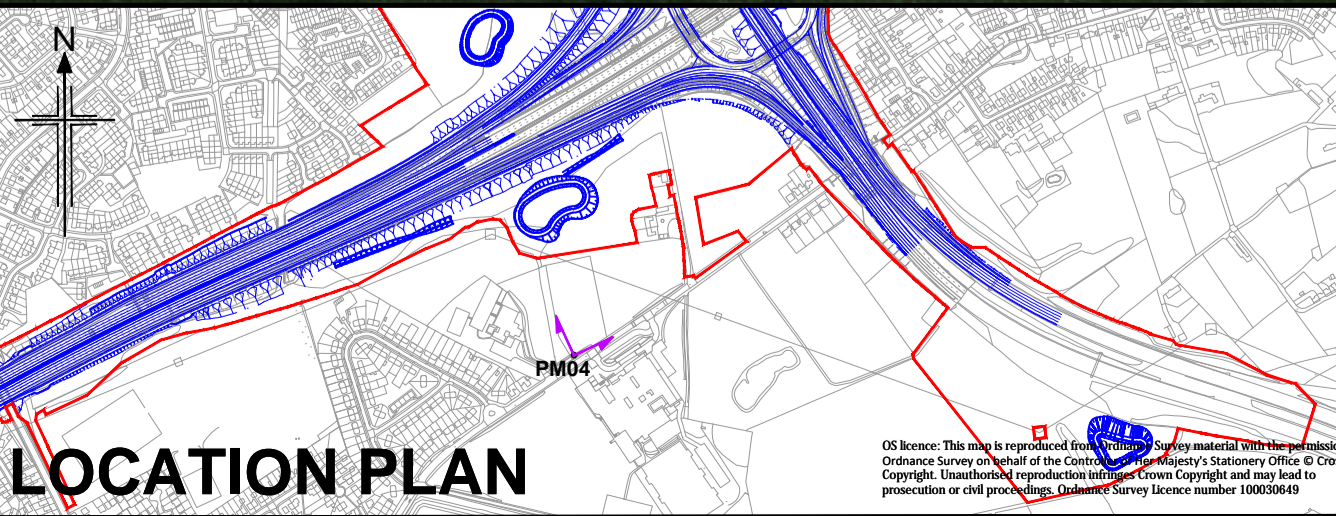

Development Consent Order Number TR010064	Development Consent Order Drawing Number TR010064/APP/6.2	Project M60/M62/M66 SIMISTER ISLAND INTERCHANGE
Regulation Regulation 5(2)(a)	Purpose of issue DCO APPLICATION	Drawing Status S4
Scale at A1 (841x594mm) N/A@A1	Client 	Jacobs No B36601F0
		Client No HE548642

Drawing Title FIGURE 7.7 PHOTOMONTAGES VIEWPOINT PM04 WINTER YEAR 1 (SHEET 1 OF 2)		Rev P01
Drawing Number HE548642 -	Originator JAC	Volume - ELS -
Location SII_MLT	Type -VS-	Role   Number   L -0207

**EXISTING - SUMMER BASELINE**



**PHOTOMONTAGE - SUMMER YEAR 15 OF OPERATION**



**VIEWPOINT PM04:** View looking north-east from Heywood Road near Parrenthorn High School to the new M60 west bound on-slip.

Visualisation type: Type 3 (in accordance with Landscape Institute Visual Representation of Development Proposals Technical Guidance Note 06/19)  
 Date and time of photograph: 08/09/21 at 14:11  
 Lighting conditions: Partially cloudy  
 OS grid reference: 382612, 405452  
 Viewpoint ground elevation: 103 m  
 Projection: Cylindrical  
 Sheet size: A1

Enlargement factor: 96% @ A1  
 Camera type: Canon EOS 5D MARK III  
 Camera lens size: 50 mm  
 Camera height above ground level: 1.6 m  
 Aperture: F/9  
 ISO: 200  
 Shutter speed: 1/800  
 Horizontal field of view: 90°  
 Vertical field of view: 27°  
 Bearing to centre of panoramic: 40°

Rev	Rev. Date	Purpose of revision	Drawn	Checked	Rev'd	Apprv'd
P02	04/11/24	UPDATED FOR DEADLINE 3	RL	JP	JP	AP
P01	22/12/23	FOR DCO APPLICATION	RL	JP	JP	BB

**NOTES:**  
 1. This photomontage is for illustrative purposes only and has been prepared in accordance with the methodology set out in Appendix 7.1 of the Environmental Statement Appendices [TR010064/APP/6.3].  
 2. For larger plans showing all viewpoint locations, refer to Figure 7.5 of the Environmental Statement Figures [TR010064/APP/6.2].  
 3. If using this photomontage to judge scale, view at A1 sheet size. The A1 sheet should be viewed centrally at a comfortable arm's length. If using this photomontage for landscape content, the figure may be viewed at A3 sheet size or viewed online.  
 4. If viewing these figures online, images will be low-resolution and therefore should only be used for information purposes. High resolution versions of the figures can be obtained from National Highways on request if required.

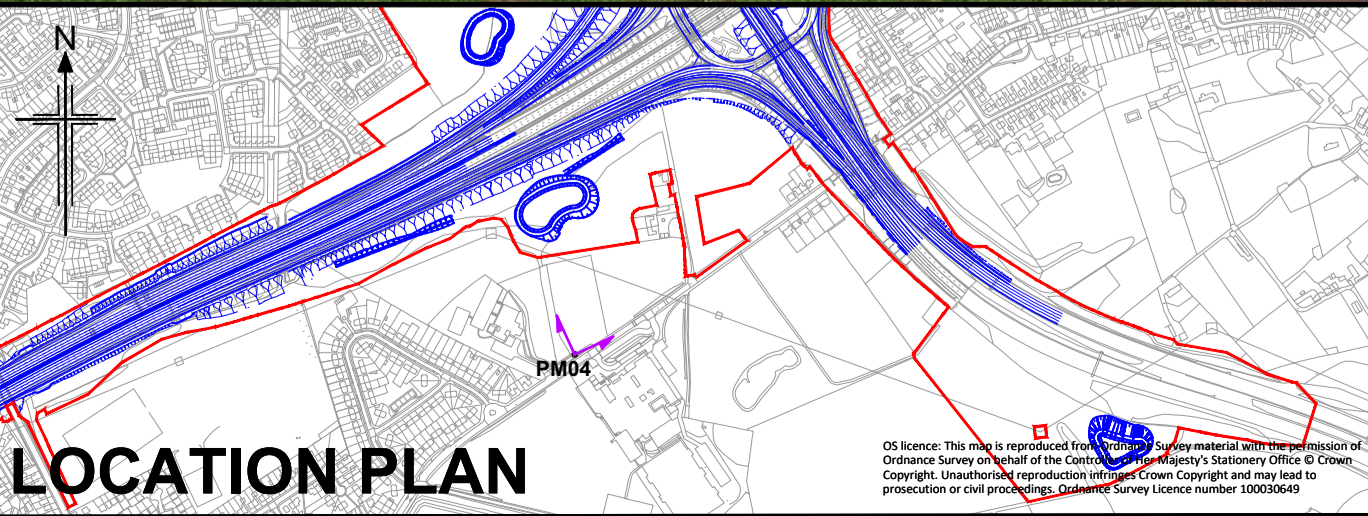

Development Consent Order Number <b>TR010064</b>	Development Consent Order Drawing Number <b>TR010064/APP/6.2</b>	Project <b>M60/M62/M66 SIMISTER ISLAND INTERCHANGE</b>
Regulation <b>Regulation 5(2)(a)</b>		Drawing Title <b>FIGURE 7.7 PHOTOMONTAGES VIEWPOINT PM04 SUMMER YEAR 15 (SHEET 2 OF 2)</b>
Purpose of Issue <b>DEADLINE 3 UPDATE</b>	Drawing Status <b>S4</b>	Jacobs No <b>B36601F0</b>
Scale at A1 (841x594mm) <b>N/A@A1</b>	Client No <b>HE548642</b>	Rev <b>P02</b>
Client <b>national highways</b>	Drawing Number <b>HE548642 - SII MLT</b>	Originator <b>JAC</b>
		Volume <b>- ELS -</b>
		Type   Role   Number <b>-VS- L -0208</b>